

Fläktförångare
NK

N° INS003000-C
03.2016



INSTALLATIONSANVISNINGAR



FRIGA-BOHN

HK[®] REFRIGERATION

INNEHÅLLSFÖRTECKNING

1. DIMENSIONER	sid 3
2. TEKNISKA DATA	sid 4-8
2. TÖVATTENRÖR	sid 8
3 NONTERING I TAK	sid 9
4 NONTERING AV MEMBRANDISTRIBUTÖR	sid 10
5. SÄKERHET	sid 10
6. ANSLUTNING AV KÖLDMEDIERÖR	sid 10
7. BULB OCH YTTRE TRYCKUTJÄMNING	sid 11
8. EILANSLUTNING	sid 11
ELVÄRME	sid 12-13
9. TILLVAL - VSC	sid 14
10. UNDERHÅLL	sid 15
11. RESERVDELAR	sid 15

1. DIMENSIONER

Ø 630 mm

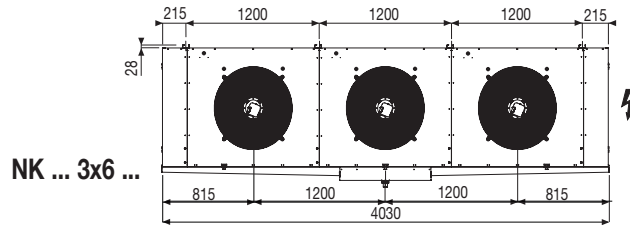
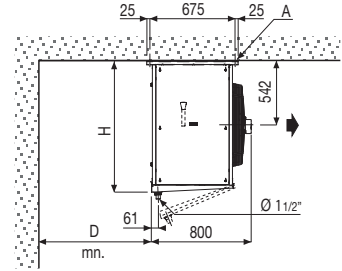
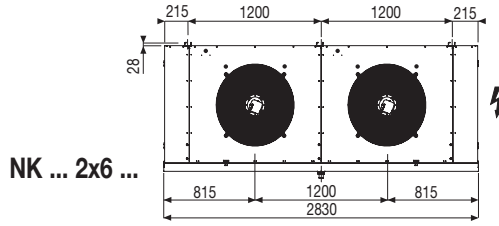
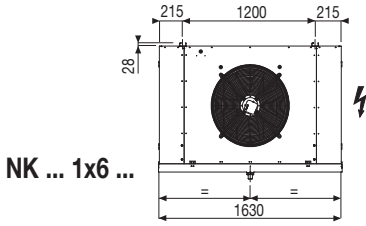

Ø	D	H
1	550	1115
2	700	1115
3	800	1158
4	850	1158

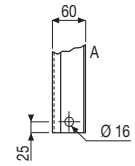
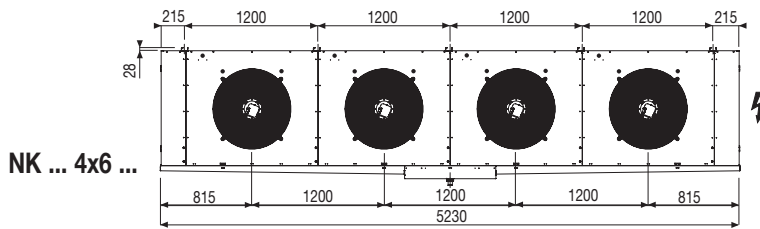

Ø 800 mm

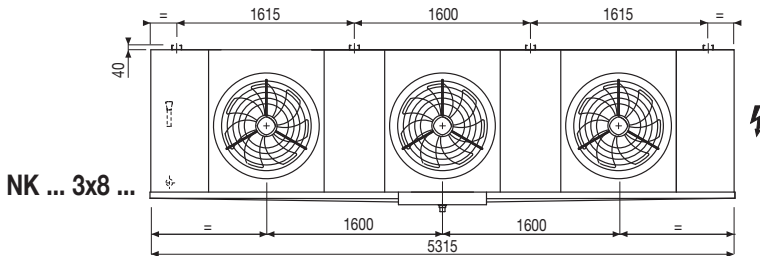
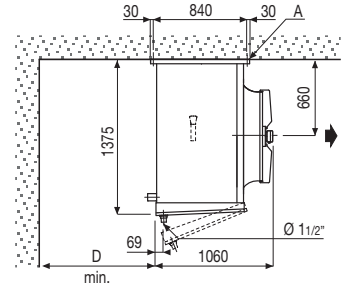
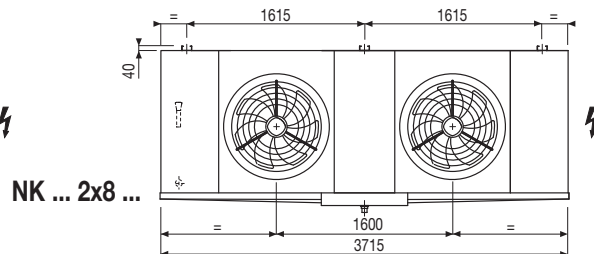
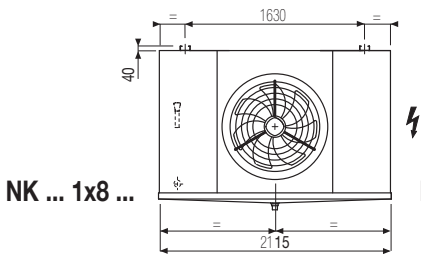

Ø	D
1	700
2	900
3	1000
4	1050

NK ... 4x8 ...

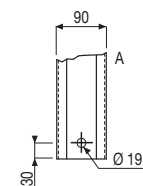
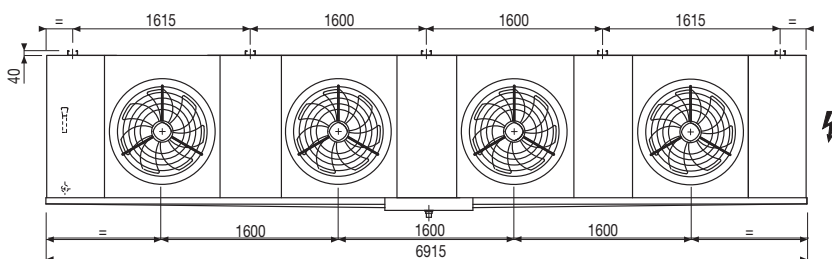

NKT ... L	Fläkt	Elavfrostning									Anslutningar		Nettovikt
		E1U			ELU			Kit ECK			In	Ut	
	antal x Ø	antal x Ø	400 V/3/50 Hz		antal x Ø	400 V/3/50 Hz		antal x Ø	400 V/3/50 Hz				
	mm	Ω	W	A	Ω	W	A	Ω	W	A	Ø D	Ø	
1x6 D/Y B2	1x630	6	6900	10,0	9	10350	14,9	3	3450	5,0	5/8"	1 3/8"	180
1x6 D/Y B3	1x630	9	10350	19,1	12	13800	19,9	3	3450	5,0	7/8"	1 5/8"	200
1x6 D/Y B4	1x630	12	13800	19,9	15	17250	24,9	3	3450	5,0	1 1/8"	1 5/8"	220
1x8 D/Y C2	1x800	6	9000	13,0	9	13500	19,5	3	4500	6,5	7/8"	1 5/8"	270
1x8 D/Y C3	1x800	9	13500	19,1	12	18000	26,0	3	4500	6,5	1 1/8"	2 1/8"	300
2x6 D/Y B2	2x630	6	13200	19,1	9	19800	28,6	3	6600	9,5	1 1/8"	2 1/8"	310
2x6 D/Y B3	2x630	9	19800	28,6	12	26400	38,1	3	6600	9,5	1 3/8"	2 1/8"	350
2x6 D/Y B4	2x630	12	26400	38,1	15	33000	47,6	3	6600	9,5	1 5/8"	2 1/8"	390
3x6 D/Y B2	3x630	6	19500	28,1	9	29250	42,2	3	9750	14,1	1 3/8"	2 1/8"	440
2x8 D/Y C2	2x800	6	17400	25,1	9	26100	37,7	3	8700	12,6	1 3/8"	2 1/8"	480
2x8 D/Y C3	2x800	9	26100	37,7	12	34800	50,2	3	8700	12,6	1 5/8"	2 5/8"	540
3x6 D/Y B3	3x630	9	29250	42,2	12	39000	56,3	3	9750	14,1	1 5/8"	2 5/8"	500
3x6 D/Y B4	3x630	12	39000	56,3	15	48750	70,4	3	9750	14,1	1 5/8"	2 5/8"	550
4x6 D/Y B2	4x630	6	25800	37,2	9	38700	55,9	3	12900	18,6	1 5/8"	2 5/8"	560
3x8 D/Y C2	3x800	6	25800	37,2	9	38700	55,9	3	12900	18,6	1 5/8"	2 5/8"	680
4x6 D/Y B3	4x630	9	38700	55,9	12	51600	74,5	3	12900	18,6	1 5/8"	2 5/8"	640
4x6 D/Y B4	4x630	12	51600	74,5	15	64500	93,1	3	12900	18,6	1 5/8"	2 5/8"	720
3x8 D/Y C3	3x800	9	38700	55,9	12	51600	74,5	3	12900	18,6	1 5/8"	2 5/8"	770
4x8 D/Y C2	4x800	6	34200	49,4	9	51300	74,0	3	17100	18,6	2x 1 3/8"	2x 2 1/8"	870
4x8 D/Y C3	4x800	9	51300	74,0	12	68400	98,7	3	17100	24,7	2x 1 5/8"	2x 2 5/8"	990

Fläktar:

Ø 630 mm 400 V/3/50 Hz - Δ = 1340 tr/min - r.p.m. - r/min - U/min. - 1900 W max - 3,2 A max - Y = 1070 tr/min - r.p.m. - r/min - U/min. - 1350 W max - 2,2 A max - IP54

Ø 800 mm 400 V/3/50 Hz - Δ = 870 tr/min - r.p.m. - r/min - U/min. - 1900 W max - 3,9 A max - Y = 630 tr/min - r.p.m. - r/min - U/min. - 1100 W max - 2 A max - IP54

NKH ... R

4,23 mm

NKH ... R	Fläkt	Elavfrostning									Anslutningar		Nettovikt
		E1U			ELU			Kit ECK			In	Ut	
	antal x Ø	antal x Ø	400 V/3/50 Hz		antal x Ø	400 V/3/50 Hz		antal x Ø	400 V/3/50 Hz				Ø D
	mm	Ω	W	A	Ω	W	A	Ω	W	A			
1x6 D/Y B1	1x630	6	6900	10,0	6	6900	10,0	-	-	-	7/8"	1 5/8"	160
1x6 D/Y B2	1x630	6	10350	14,9	9	10350	14,9	3	3450	5,0	1 1/8"	1 5/8"	180
1x6 D/Y B3	1x630	9	13800	19,9	12	13800	19,9	3	3450	5,0	1 1/8"	1 5/8"	200
1x8 D/Y C1	1x800	6	9000	13,0	6	9000	13,0	-	-	-	1 3/8"	2 1/8"	240
1x8 D/Y C2	1x800	6	9000	13,0	9	13500	19,5	3	4500	6,5	1 3/8"	2 1/8"	270
2x6 D/Y B1	2x630	6	13200	19,1	6	13200	19,1	-	-	-	1 3/8"	2 1/8"	270
2x6 D/Y B2	2x630	6	19800	28,6	9	19800	28,6	3	6600	9,5	1 3/8"	2 1/8"	300
2x6 D/Y B3	2x630	9	26400	38,1	12	26400	38,1	3	6600	9,5	1 5/8"	2 1/8"	340
3x6 D/Y B1	3x630	6	19500	28,1	6	19500	28,1	-	-	-	1 5/8"	2 1/8"	370
2x8 D/Y C1	2x800	6	17400	25,1	6	17400	25,1	-	-	-	1 5/8"	2 5/8"	420
2x8 D/Y C2	2x800	6	17400	25,1	9	26100	37,7	3	8700	12,6	1 5/8"	2 5/8"	480
3x6 D/Y B2	3x630	6	19500	28,1	9	29250	42,2	3	9750	14,1	2x 1 3/8"	2x 2 1/8"	430
3x6 D/Y B3	3x630	9	29250	42,2	12	39000	56,3	3	9750	14,1	1 5/8"	2 5/8"	490
4x6 D/Y B1	4x630	6	25800	37,2	6	25800	37,2	-	-	-	2x 1 5/8"	2x 2 1/8"	480
3x8 D/Y C1	3x800	6	25800	37,2	6	25800	37,2	-	-	-	1 5/8"	2 5/8"	570
4x6 D/Y B2	4x630	6	25800	37,2	9	38700	55,9	3	12900	18,6	2x 1 3/8"	2x 2 1/8"	550
4x6 D/Y B3	4x630	9	38700	55,9	12	51600	74,5	3	12900	18,6	2x 1 5/8"	2x 2 1/8"	630
3x8 D/Y C2	3x800	6	25800	37,2	9	38700	55,9	3	12900	18,6	2x 1 5/8"	2x 2 1/8"	670
4x8 D/Y C1	4x800	6	34200	49,4	6	34200	49,4	-	-	-	2x 1 5/8"	2x 2 5/8"	740
4x8 D/Y C2	4x800	6	34200	49,4	9	51300	74,0	3	17100	24,7	2x 1 5/8"	2x 2 5/8"	840

NKH ... L

6,35 mm

NKH ... L	Fläkt	Elavfrostning									Anslutningar		Nettovikt
		E1U			ELU			Kit ECK			In	Ut	
	antal x Ø	antal x Ø	400 V/3/50 Hz		antal x Ø	400 V/3/50 Hz		antal x Ø	400 V/3/50 Hz				Ø D
	mm	Ω	W	A	Ω	W	A	Ω	W	A			
1x6 D/Y B1	1x630	6	6900	10,0	6	6900	10,0	-	-	-	7/8"	1 3/8"	160
1x6 D/Y B2	1x630	6	6900	10,0	9	10350	14,9	3	3450	5,0	1 1/8"	1 5/8"	180
1x6 D/Y B3	1x630	9	10350	14,9	12	13800	19,9	3	3450	5,0	1 1/8"	1 5/8"	190
1x8 D/Y C1	1x800	6	9000	13,0	6	9000	13,0	-	-	-	1 3/8"	1 5/8"	230
1x8 D/Y C2	1x800	6	9000	13,0	9	13500	19,5	3	4500	6,5	1 3/8"	2 1/8"	260
2x6 D/Y B1	2x630	6	13200	19,1	6	13200	19,1	-	-	-	1 3/8"	2 1/8"	260
2x6 D/Y B2	2x630	6	13200	19,1	9	19800	28,6	3	6600	9,5	1 3/8"	2 1/8"	290
2x6 D/Y B3	2x630	9	19800	28,6	12	26400	38,1	3	6600	9,5	1 5/8"	2 1/8"	330
3x6 D/Y B1	3x630	6	19500	28,1	6	19500	28,1	-	-	-	1 5/8"	2 1/8"	360
2x8 D/Y C1	2x800	6	17400	25,1	6	17400	25,1	-	-	-	1 5/8"	2 1/8"	400
2x8 D/Y C2	2x800	6	17400	25,1	9	26100	37,7	3	8700	12,6	1 5/8"	2 5/8"	460
3x6 D/Y B2	3x630	6	19500	28,1	9	29250	42,2	3	9750	14,1	2x 1 3/8"	2x 2 1/8"	410
4x6 D/Y B1	4x630	6	25800	37,2	6	25800	37,2	-	-	-	2x 1 5/8"	2x 2 1/8"	470
3x8 D/Y C1	3x800	6	25800	37,2	6	25800	37,2	-	-	-	1 5/8"	2 5/8"	550
3x6 D/Y B3	3x630	9	29250	42,2	12	39000	56,3	3	9750	14,1	1 5/8"	2 5/8"	460
4x6 D/Y B2	4x630	6	25800	37,2	9	38700	55,9	3	12900	18,6	2x 1 3/8"	2x 2 1/8"	530
3x8 D/Y C2	3x800	6	25800	37,2	9	38700	55,9	3	12900	18,6	2x 1 5/8"	2x 2 1/8"	650
4x6 D/Y B3	4x630	9	38700	55,9	12	51600	74,5	3	12900	18,6	2x 1 5/8"	2x 2 1/8"	600
4x8 D/Y C1	4x800	6	34200	49,4	6	34200	49,4	-	-	-	2x 1 5/8"	2x 2 1/8"	720
4x8 D/Y C2	4x800	6	34200	49,4	9	51300	74,0	3	17100	24,7	2x 1 5/8"	2x 2 1/8"	800

Ventilateur - Fan - Ventilador - Ventilator :

Ø 630 mm: 400 V/3/50 Hz - Δ = 1340 tr/min - r.p.m. - r/min - U/min. - 1900 W max - 3,2 A max - Y = 1070 tr/min - r.p.m. - r/min - U/min. - 1350 W max - 2,2 A max - IP54
 Ø 800 mm: 400 V/3/50 Hz - Δ = 870 tr/min - r.p.m. - r/min - U/min. - 1900 W max - 3,9 A max - Y = 630 tr/min - r.p.m. - r/min - U/min. - 1100 W max - 2 A max - IP54

NKT ... C

6,35 mm

NKT ... C	Fläkt	Elavfrostning			Anslutningar		Nettovikt
	antal x Ø	antal x Ø	400 V/3/50 Hz		In	Ut	
	mm	Ω	W	A	Ø D	Ø	
1x6 D/Y B2	1x630	9	10350	14,9	5/8"	1 3/8"	200
1x6 D/Y B3	1x630	12	13800	19,9	7/8"	1 5/8"	220
1x6 D/Y B4	1x630	15	17250	24,9	1 1/8"	2 1/8"	240
1x8 D/Y C2	1x800	9	13500	19,5	1 1/8"	2 1/8"	290
1x8 D/Y C3	1x800	12	18000	26,0	1 1/8"	2 1/8"	330
2x6 D/Y B2	2x630	9	19800	28,6	1 1/8"	2 1/8"	340
2x6 D/Y B3	2x630	12	26400	38,1	1 3/8"	2 5/8"	390
2x6 D/Y B4	2x630	15	33000	47,6	1 5/8"	2 5/8"	430
3x6 D/Y B2	3x630	9	29250	42,2	1 5/8"	2 5/8"	490
2x8 D/Y C2	2x800	9	26100	37,7	1 3/8"	2 5/8"	520
3x6 D/Y B3	3x630	12	39000	56,3	1 5/8"	2 5/8"	550
2x8 D/Y C3	2x800	12	34800	50,2	1 5/8"	2 5/8"	580
4x6 D/Y B2	4x630	9	38700	55,9	1 5/8"	2 5/8"	630
3x6 D/Y B4	3x630	15	48750	70,4	1 5/8"	2 5/8"	620
3x8 D/Y C2	3x800	9	38700	55,9	2x 1 3/8"	2x 2 1/8"	740
4x6 D/Y B3	4x630	12	51600	74,5	2x 1 5/8"	2x 2 5/8"	720
4x6 D/Y B4	4x630	15	64500	93,1	1 5/8"	3 1/8"	800
3x8 D/Y C3	3x800	12	51600	74,5	1 5/8"	3 1/8"	840
4x8 D/Y C2	4x800	9	51300	74,0	2x 1 3/8"	2x 2 5/8"	940
4x8 D/Y C3	4x800	12	68400	98,7	2x 1 5/8"	2x 2 5/8"	1080

NKT ... S

9 mm

NKT ... S	Fläkt	Elavfrostning			Anslutningar		Nettovikt
	antal x Ø	antal x Ø	400 V/3/50 Hz		In	Ut	
	mm	Ω	W	A	Ø D	Ø	
1x6 D/Y B2	1x630	9	10350	14,9	5/8"	1 3/8"	190
1x6 D/Y B3	1x630	12	13800	19,9	7/8"	1 5/8"	220
1x6 D/Y B4	1x630	15	17250	24,9	1 1/8"	2 1/8"	240
1x8 D/Y C2	1x800	9	13500	19,5	1 1/8"	2 1/8"	280
1x8 D/Y C3	1x800	12	18000	26,0	1 1/8"	2 1/8"	320
2x6 D/Y B2	2x630	9	19800	28,6	1 1/8"	2 1/8"	330
2x6 D/Y B3	2x630	12	26400	38,1	1 3/8"	2 1/8"	370
2x6 D/Y B4	2x630	15	33000	47,6	1 5/8"	2 5/8"	410
3x6 D/Y B2	3x630	9	29250	42,2	1 5/8"	2 5/8"	470
2x8 D/Y C2	2x800	9	26100	37,7	1 5/8"	2 5/8"	500
3x6 D/Y B3	3x630	12	39000	56,3	1 5/8"	2 5/8"	530
2x8 D/Y C3	2x800	12	34800	50,2	1 5/8"	2 5/8"	560
4x6 D/Y B2	4x630	9	38700	55,9	1 5/8"	2 5/8"	610
3x6 D/Y B4	3x630	15	48750	70,4	1 5/8"	2 5/8"	590
3x8 D/Y C2	3x800	9	38700	55,9	2x 1 3/8"	2x 2 1/8"	710
4x6 D/Y B3	4x630	12	51600	74,5	2x 1 5/8"	2x 2 1/8"	690
3x8 D/Y C3	3x800	12	51600	74,5	2x 1 5/8"	2x 2 5/8"	800
4x6 D/Y B4	4x630	15	64500	93,1	2x 1 5/8"	2x 2 5/8"	770
4x8 D/Y C2	4x800	9	51300	74,0	2x 1 3/8"	2x 2 5/8"	910
4x8 D/Y C3	4x800	12	68400	98,7	2x 1 5/8"	2x 2 5/8"	1030

Fläktar:

Ø 630 mm: 400 V/3/50 Hz - Δ = 1340 tr/min - r.p.m. - r/min - U/min. - 1900 W max - 3,2 A max - Y = 1070 tr/min - r.p.m. - r/min - U/min. - 1350 W max - 2,2 A max - IP54
 Ø 800 mm: 400 V/3/50 Hz - Δ = 870 tr/min - r.p.m. - r/min - U/min. - 1900 W max - 3,9 A max - Y = 630 tr/min - r.p.m. - r/min - U/min. - 1100 W max - 2 A max - IP54

NKH ... C

6,35 mm

NKH ... C	Fläkt	Elavfrostning			Anslutningar		Nettovikt
	antal x Ø	antal x Ø	400 V/3/50 Hz		In	Ut	
	mm	Ω	W	A	Ø D	Ø	
1x6 D/Y B1	1x630	6	6900	10,0	7/8"	1 5/8"	170
1x6 D/Y B2	1x630	9	10350	14,9	1 1/8"	2 1/8"	190
1x6 D/Y B3	1x630	12	13800	19,9	1 3/8"	2 1/8"	210
1x8 D/Y C1	1x800	6	9000	13,0	1 3/8"	2 1/8"	250
1x8 D/Y C2	1x800	9	13500	19,5	1 3/8"	2 1/8"	280
2x6 D/Y B1	2x630	6	13200	19,1	1 3/8"	2 1/8"	290
2x6 D/Y B2	2x630	9	19800	28,6	1 5/8"	2 5/8"	320
3x6 D/Y B1	3x630	6	19500	28,1	1 5/8"	2 5/8"	410
2x6 D/Y B3	2x630	12	26400	38,1	1 5/8"	2 5/8"	360
2x8 D/Y C1	2x800	6	17400	25,1	1 5/8"	2 5/8"	440
2x8 D/Y C2	2x800	9	26100	37,7	1 5/8"	2 5/8"	500
3x6 D/Y B2	3x630	9	29250	42,2	2x 1 3/8"	2x 2 1/8"	460
3x8 D/Y C1	3x800	6	25800	37,2	1 5/8"	2 5/8"	600
4x6 D/Y B1	4x630	6	25800	37,2	2x 1 5/8"	2x 2 1/8"	520
3x6 D/Y B3	3x630	12	39000	56,3	2x 1 5/8"	2x 2 1/8"	520
3x8 D/Y C2	3x800	9	38700	55,9	2x 1 5/8"	2x 2 5/8"	700
4x6 D/Y B3	4x630	12	51600	74,5	2x 1 5/8"	2x 2 5/8"	670
4x8 D/Y C1	4x800	6	34200	49,4	2x 1 5/8"	2x 2 5/8"	780

NKH ... S

9 mm

NKH ... S	Fläkt	Elavfrostning			Anslutningar		Nettovikt
	antal x Ø	antal x Ø	400 V/3/50 Hz		In	Ut	
	mm	Ω	W	A	Ø D	Ø	
1x6 D/Y B1	1x630	6	6900	10,0	7/8"	1 5/8"	170
1x6 D/Y B2	1x630	9	10350	14,9	1 1/8"	1 5/8"	190
1x8 D/Y C1	1x800	6	9000	13,0	1 3/8"	2 1/8"	250
1x6 D/Y B3	1x630	12	13800	19,9	1 1/8"	2 1/8"	210
2x6 D/Y B1	2x630	6	13200	19,1	1 3/8"	2 1/8"	280
1x8 D/Y C2	1x800	9	13500	19,5	1 3/8"	2 1/8"	280
2x6 D/Y B2	2x630	9	19800	28,6	1 5/8"	2 5/8"	320
3x6 D/Y B1	3x630	6	19500	28,1	1 5/8"	2 5/8"	400
2x8 D/Y C1	2x800	6	17400	25,1	1 5/8"	2 5/8"	430
2x6 D/Y B3	2x630	12	26400	38,1	1 5/8"	2 5/8"	360
2x8 D/Y C2	2x800	9	26100	37,7	1 5/8"	2 5/8"	480
4x6 D/Y B1	4x630	6	25800	37,2	2x 1 3/8"	2x 2 1/8"	510
3x6 D/Y B2	3x630	9	29250	42,2	2x 1 1/8"	2x 2 1/8"	450
3x8 D/Y C1	3x800	6	25800	37,2	1 5/8"	2 5/8"	590
4x6 D/Y B2	4x630	9	38700	55,9	2x 1 3/8"	2x 2 1/8"	570
3x6 D/Y B3	3x630	12	39000	56,3	2x 1 3/8"	2x 2 1/8"	510
3x8 D/Y C2	3x800	9	38700	55,9	2x 1 5/8"	2x 2 1/8"	670
4x6 D/Y B3	4x630	12	51600	74,5	2x 1 3/8"	2x 2 5/8"	640
4x8 D/Y C1	4x800	6	34200	49,4	2x 1 5/8"	2x 2 5/8"	770
4x8 D/Y C2	4x800	9	51300	74,0	2x 1 5/8"	2x 2 5/8"	860

Fläktar:

Ø 630 mm: 400 V/3/50 Hz - Δ = 1340 tr/min - r.p.m. - r/min - U/min. - 1900 W max - 3,2 A max - Y = 1070 tr/min - r.p.m. - r/min - U/min. - 1350 W max - 2,2 A max - IP54
 Ø 800 mm: 400 V/3/50 Hz - Δ = 870 tr/min - r.p.m. - r/min - U/min. - 1900 W max - 3,9 A max - Y = 630 tr/min - r.p.m. - r/min - U/min. - 1100 W max - 2 A max - IP54

NKT ... S	Fläkt		Elavfrostning		Anslutningar		Nettovikt
	antal x Ø	antal x Ø	400 V/3/50 Hz		In	Ut	
			mm	Ω			
1x6 D/Y B2	1x630	9	10350	14,9	5/8"	1 3/8"	190
1x6 D/Y B3	1x630	12	13800	19,9	7/8"	1 5/8"	210
1x6 D/Y B4	1x630	15	17250	24,9	1 1/8"	2 1/8"	230
1x8 D/Y C2	1x800	9	13500	19,5	1 1/8"	2 1/8"	280
1x8 D/Y C3	1x800	12	18000	26,0	1 1/8"	2 1/8"	310
2x6 D/Y B2	2x630	9	19800	28,6	1 1/8"	2 1/8"	320
2x6 D/Y B3	2x630	12	26400	38,1	1 3/8"	2 1/8"	360
2x6 D/Y B4	2x630	15	33000	47,6	1 5/8"	2 5/8"	400
3x6 D/Y B2	3x630	9	29250	42,2	1 5/8"	2 5/8"	460
2x8 D/Y C2	2x800	9	26100	37,7	1 3/8"	2 5/8"	490
3x6 D/Y B3	3x630	12	39000	56,3	1 5/8"	2 5/8"	520
2x8 D/Y C3	2x800	12	34800	50,2	1 5/8"	2 5/8"	550
4x6 D/Y B2	4x630	9	38700	55,9	1 5/8"	2 5/8"	600
3x6 D/Y B4	3x630	15	48750	70,4	1 5/8"	2 5/8"	580
3x8 D/Y C2	3x800	9	38700	55,9	1 5/8"	2 5/8"	700
4x6 D/Y B3	4x630	12	51600	74,5	2x 1 5/8"	2x 2 1/8"	670
3x8 D/Y C3	3x800	12	51600	74,5	1 5/8"	3 1/8"	790
4x6 D/Y B4	4x630	15	64500	93,1	1 5/8"	3 1/8"	750
4x8 D/Y C2	4x800	9	51300	74,0	2x 1 3/8"	2x 2 5/8"	890
4x8 D/Y C3	4x800	12	68400	98,7	2x 1 5/8"	2x 2 5/8"	1010

Fläktar:

Ø 630 mm : 400 V/3/50 Hz - Δ = 1340 tr/min - r.p.m. - r/min - U/min. - 1900 W max - 3,2 A max - Y = 1070 tr/min - r.p.m. - r/min - U/min. - 1350 W max - 2,2 A max - IP54
 Ø 800 mm : 400 V/3/50 Hz - Δ = 870 tr/min - r.p.m. - r/min - U/min. - 1900 W max - 3,9 A max - Y = 630 tr/min - r.p.m. - r/min - U/min. - 1100 W max - 2 A max - IP54

2. TÖVATTENRÖR

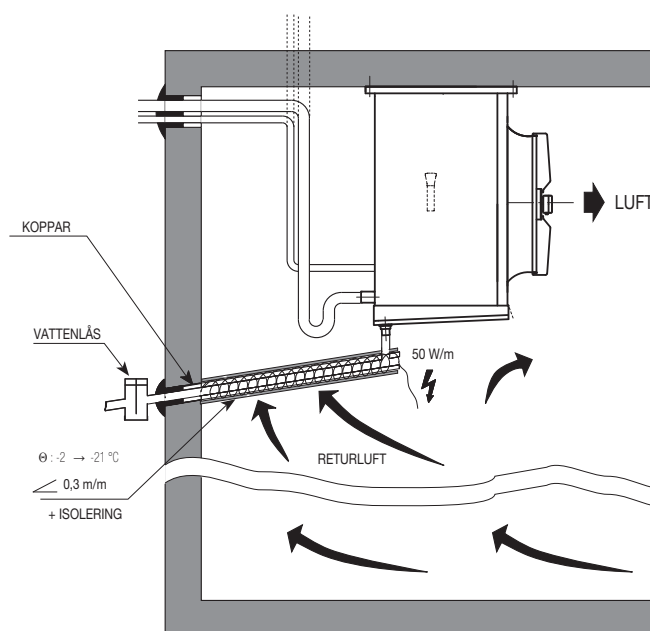
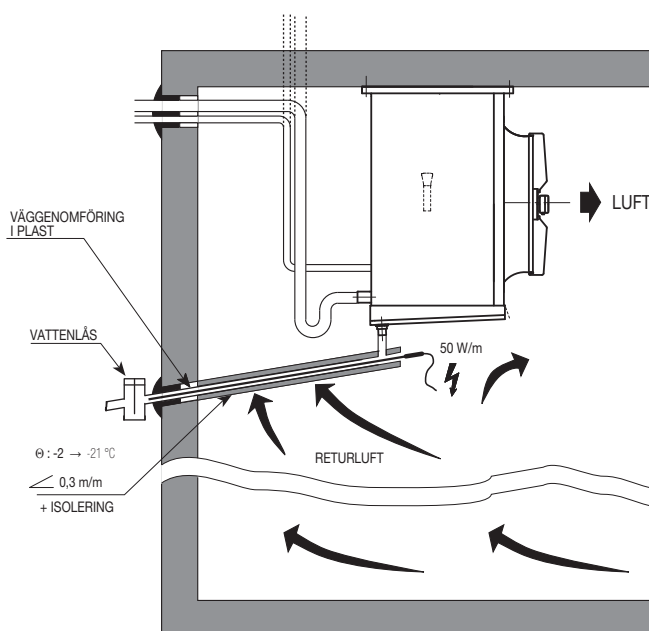

3. MONTERING I TAK

→ ① → ② → ③ → ④ → ⑤

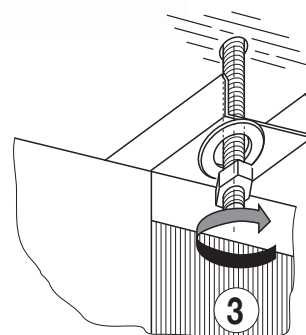
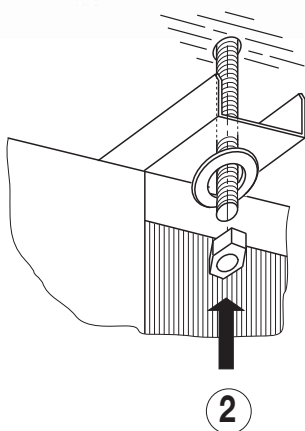
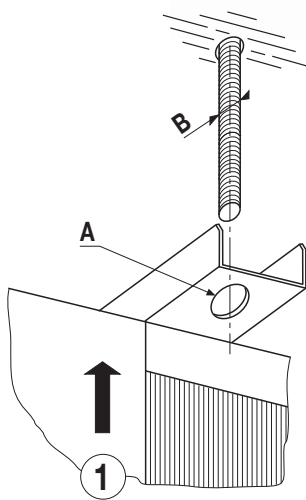
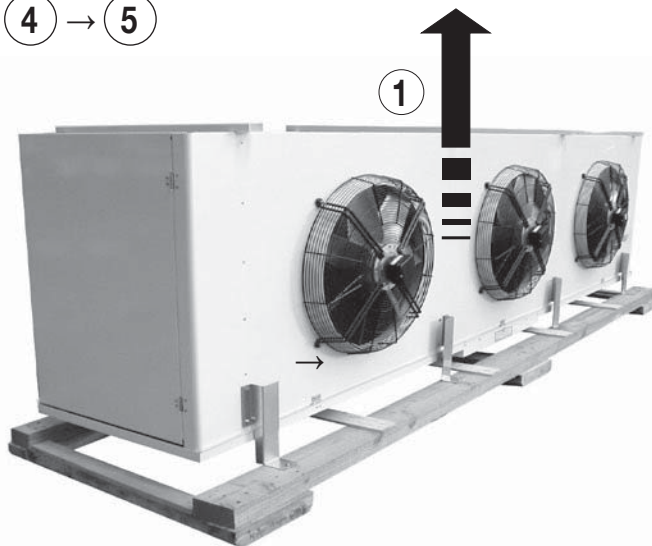

	A	B
Ø 630 mm	16 mm	M14
Ø 800 mm	19 mm	M16



LÅSMUTTRAR

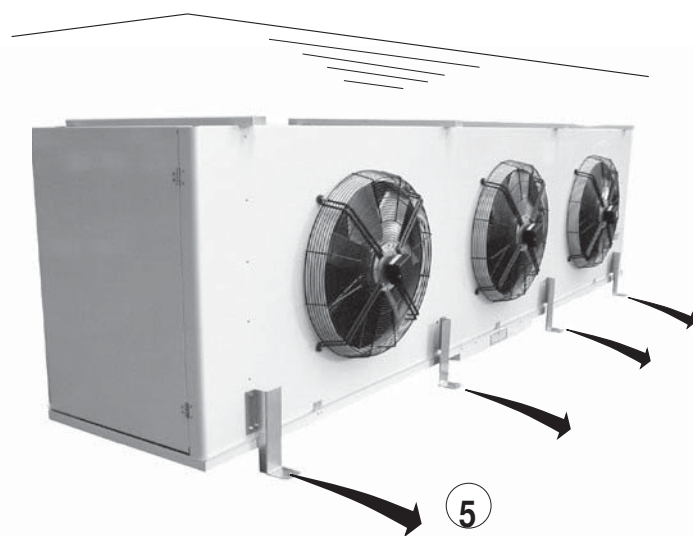
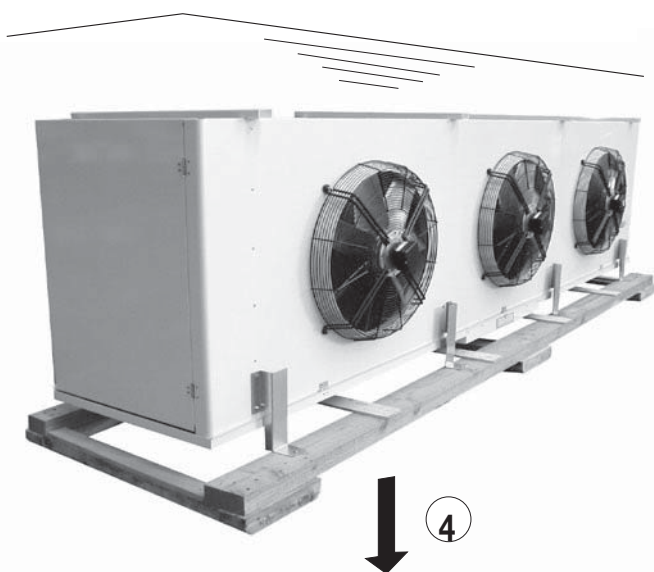

4. MONTERING AV MEMBRANDISTRIBUTÖR

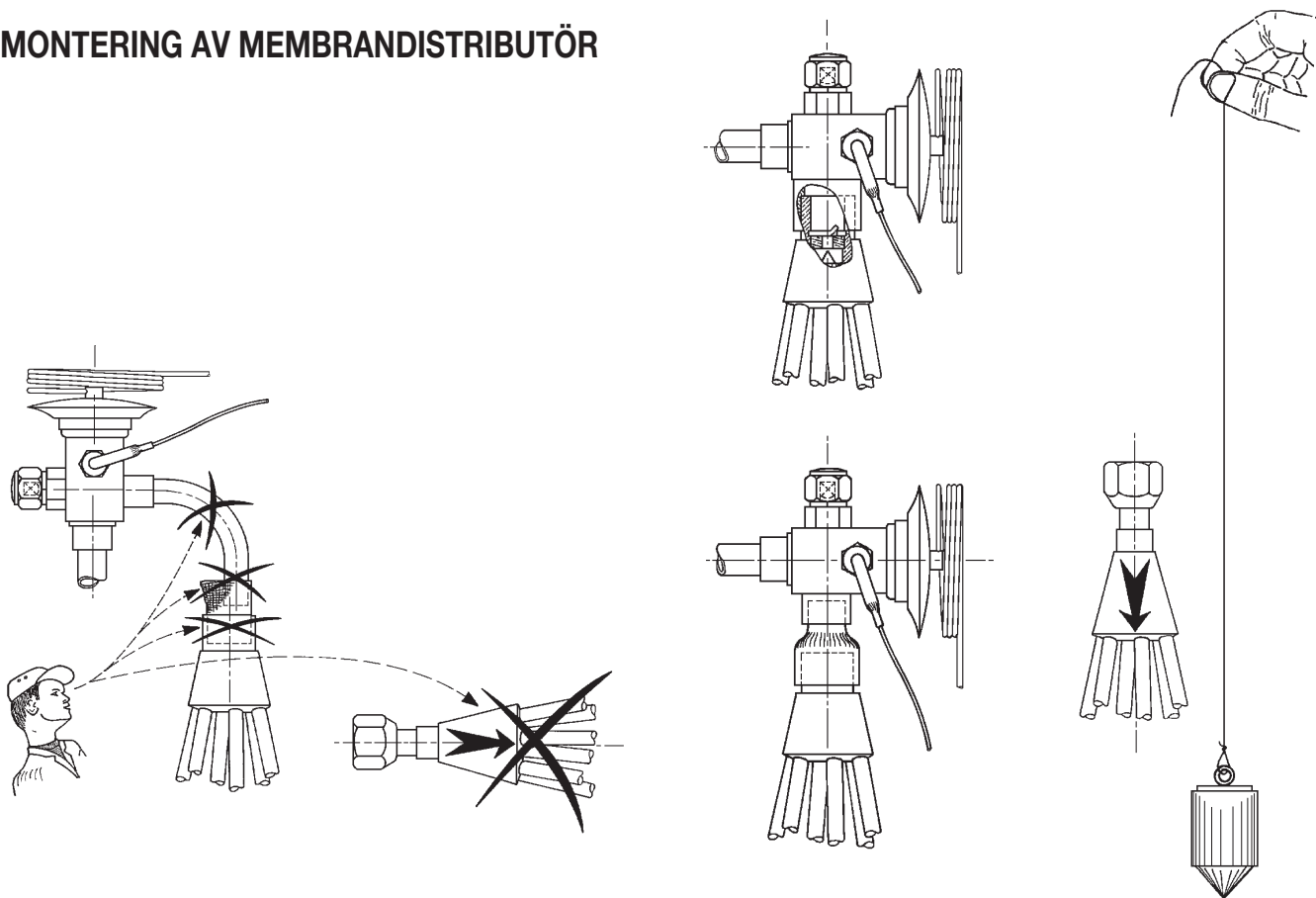

5. SÄKERHET

→ ① → ② → ③ → ④

0,2 bar

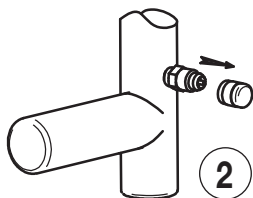
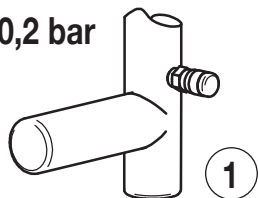

0 bar

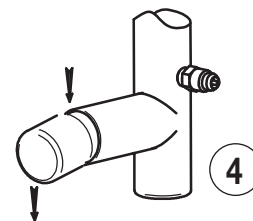
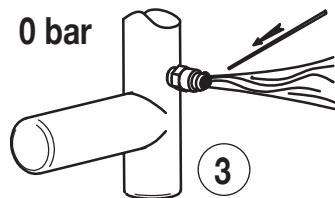

6. KÖLDMEDIERÖR

→ ① → ②

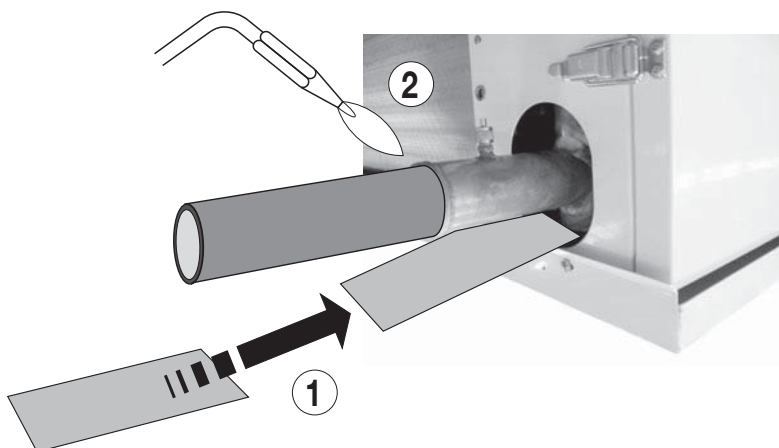

7. BULB OCH YTTRE TRYCKUTJÄMNING

→ ① → ②

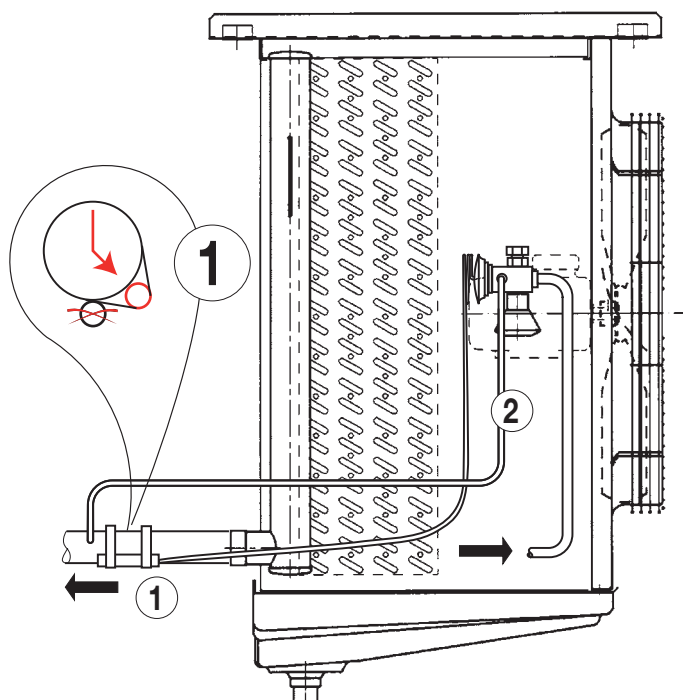

8. ELANSLUTNING

FLÄKTAR

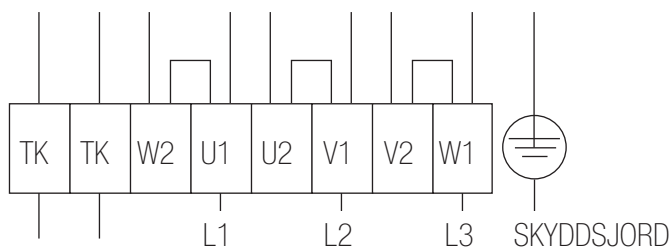

Δ : ANSLUTNING

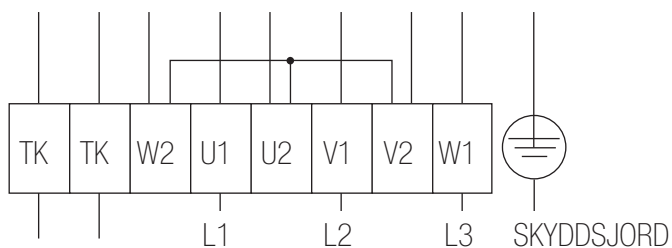

Y : ANSLUTNING

VARNING



Bryt strömmen
innan arbeten påbörjas på enheten



Ej inkopplade
överbelastningsskydd
= makulerad garanti

Kontrollera aggregatets märkskylt!

ELVÄRME

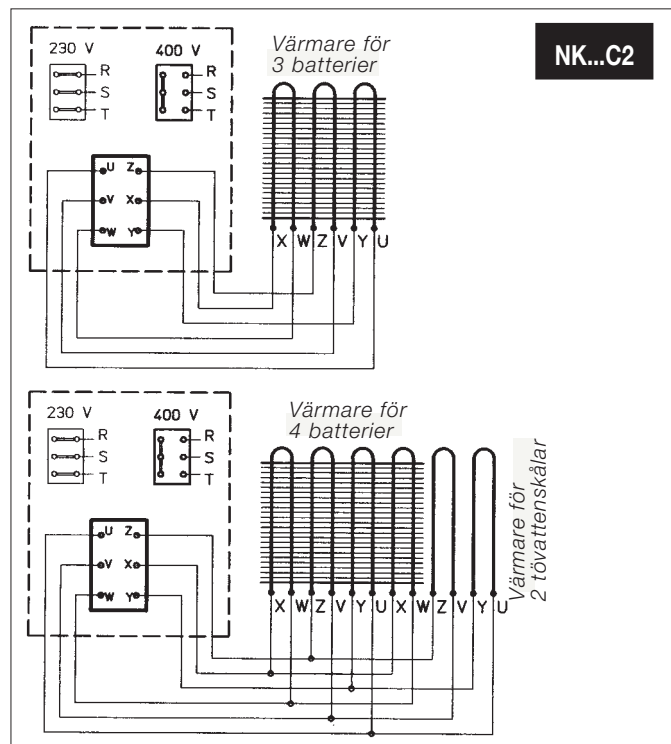
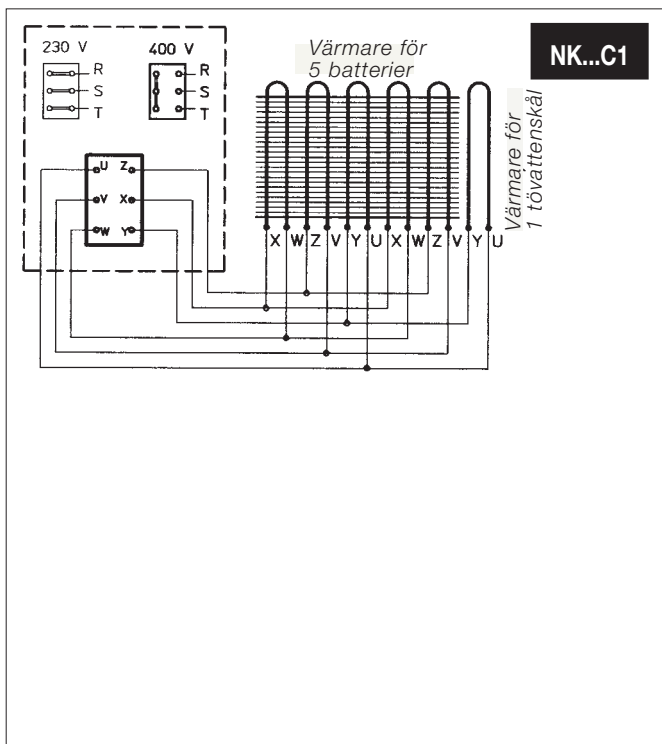
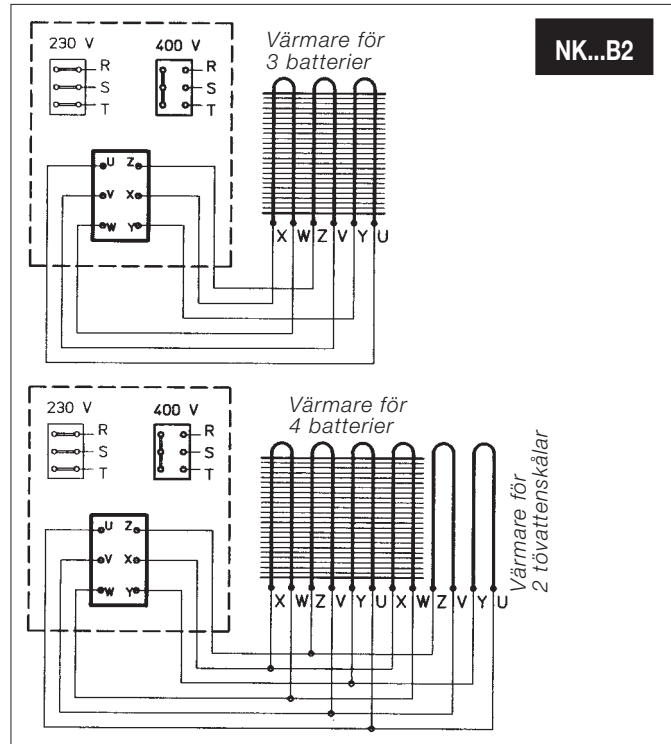
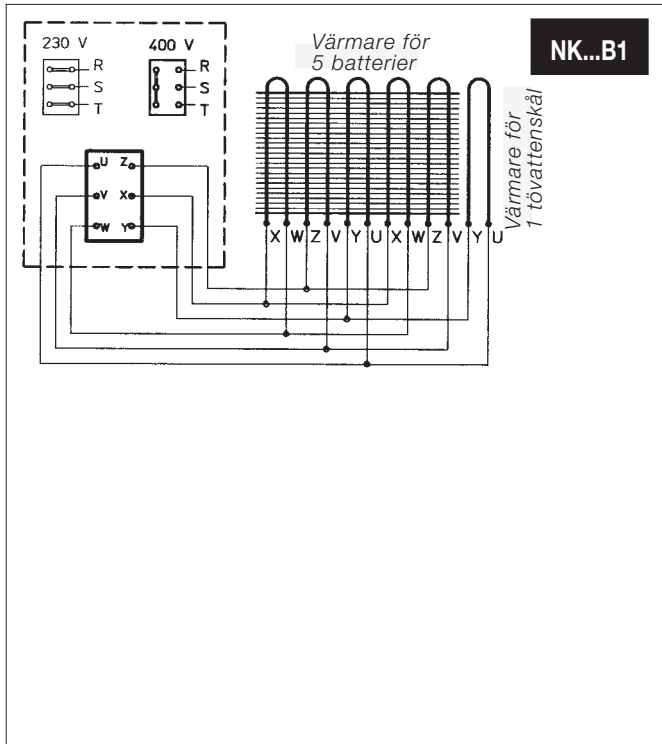
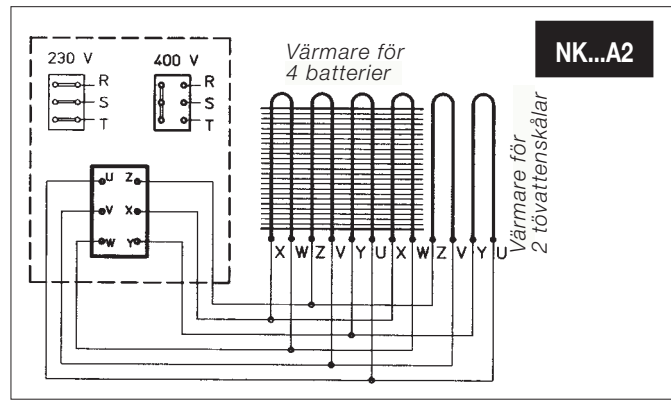
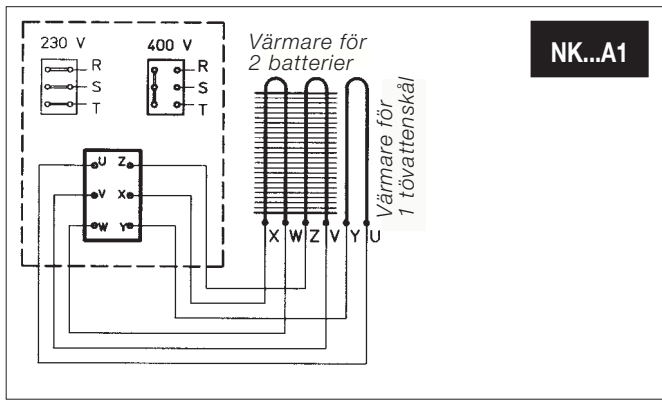

ELVÄRME

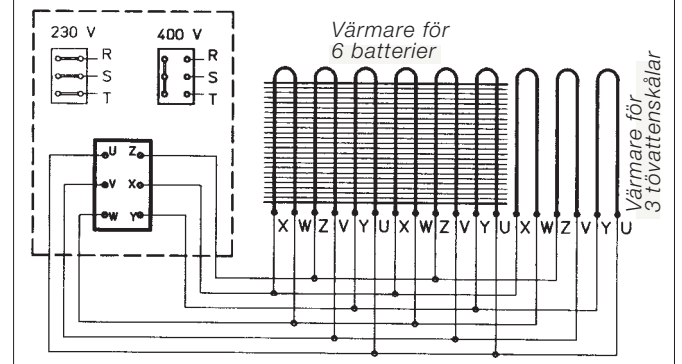
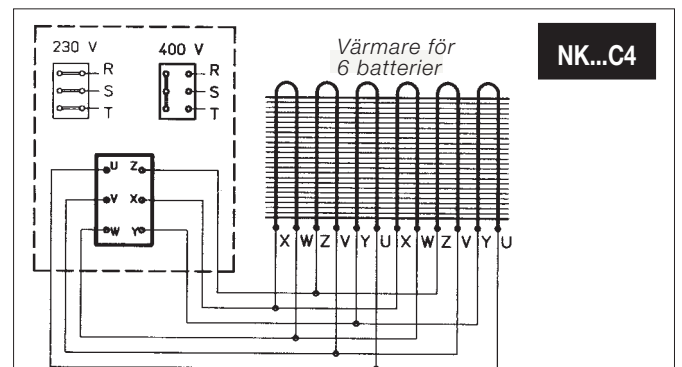
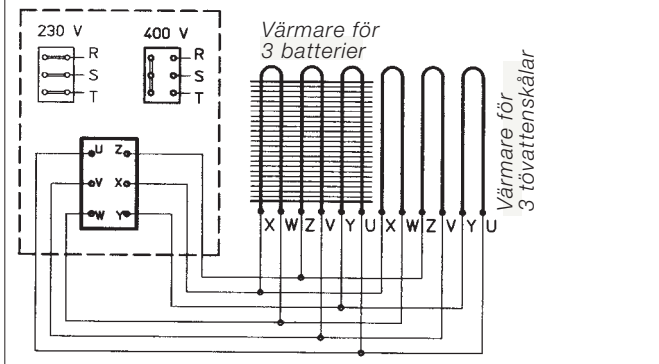
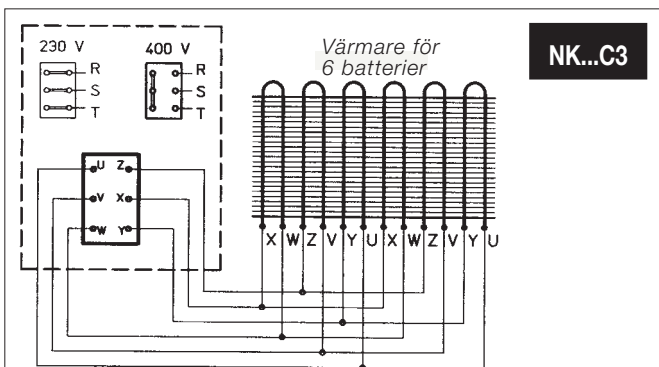
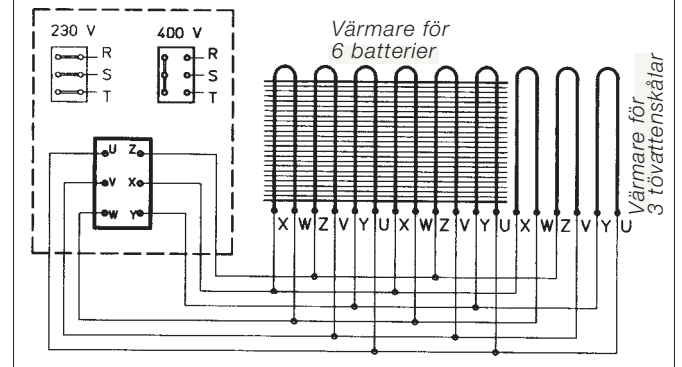
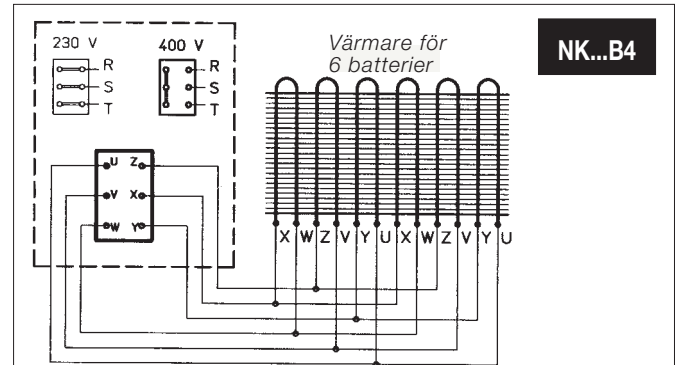
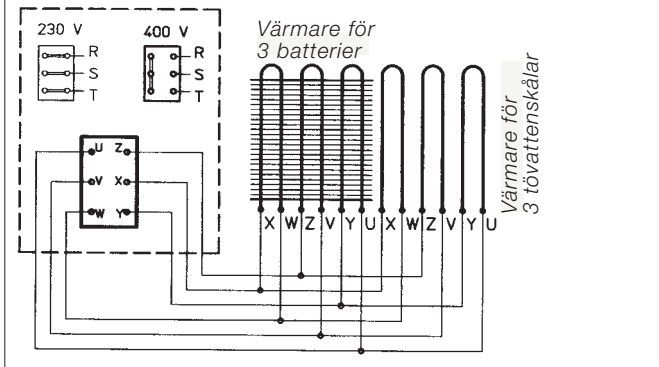
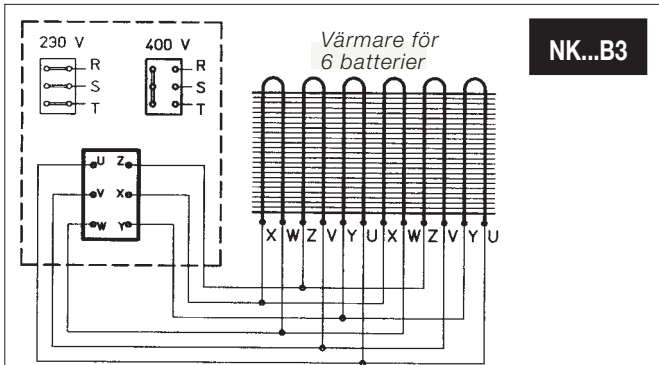
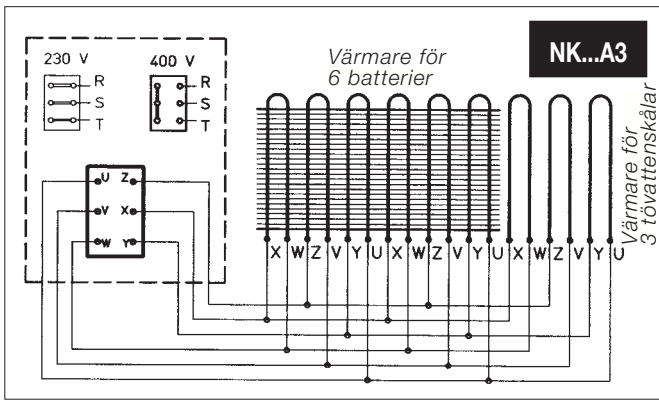

9. TILLVAL - VSC

NK630 OPTION VSC
NK630 VSC OPTION
NK630 OPCIÓN VSC
NK630 OPTION VSC

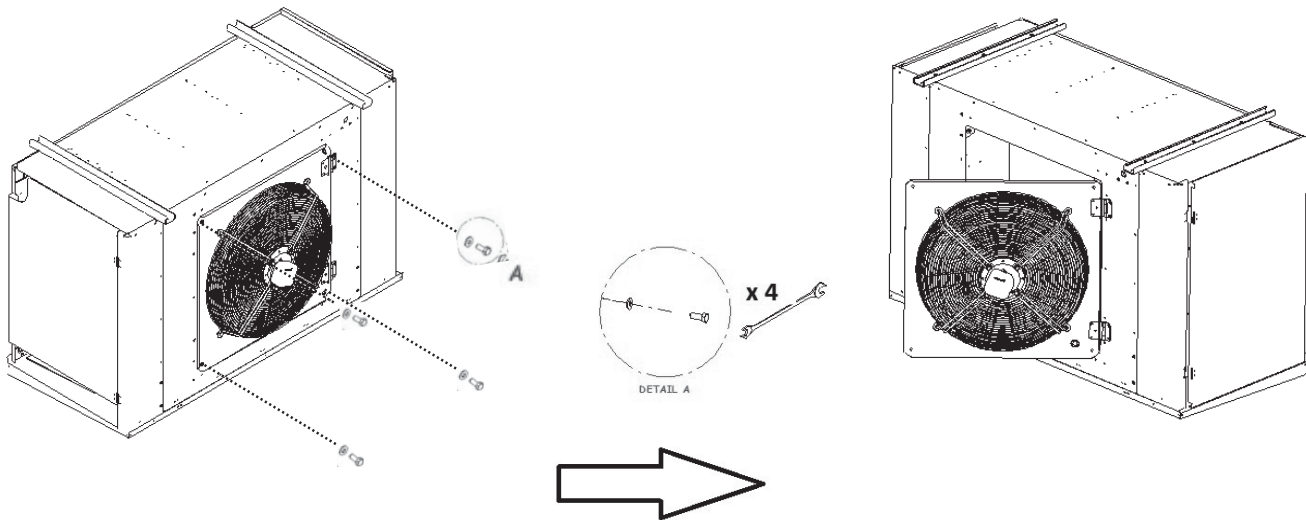

NK800 OPTION VSC
NK800 VSC OPTION
NK800 OPCIÓN VSC
NK800 OPTION VSC

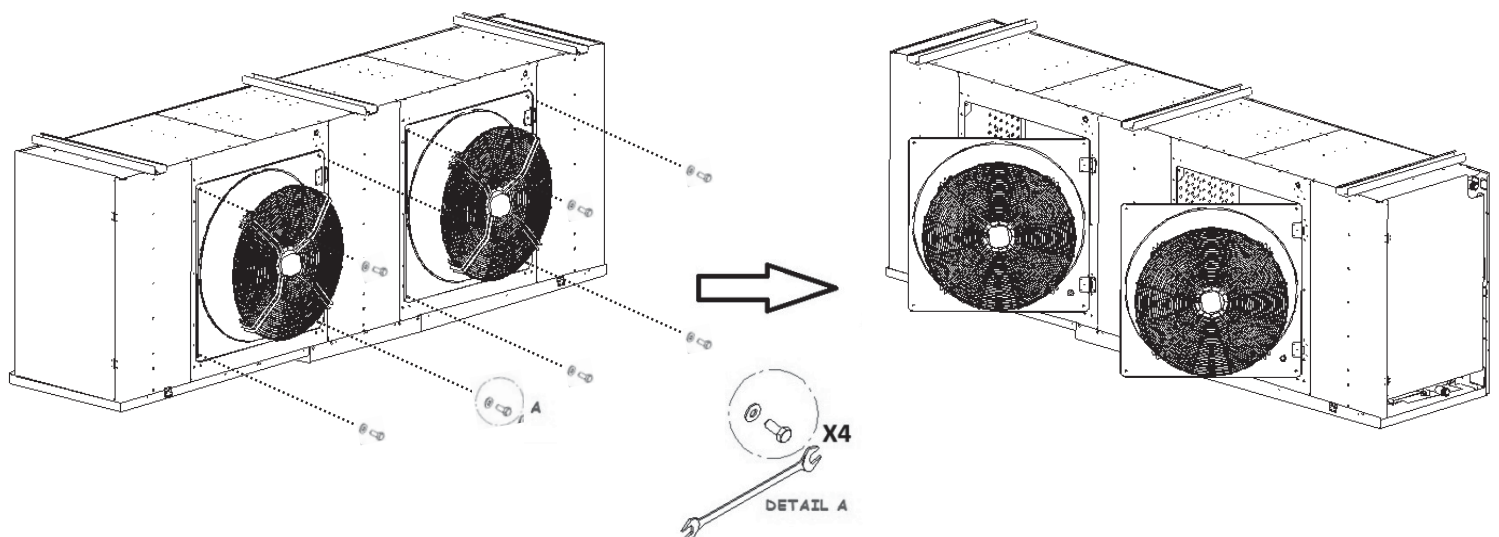

10. UNDERHÅLL

Rengör regelbundet följande med mildt rengöringsmedel och eftersköj med vatten:

- värmeväxlare: skydda elmotorn mot vatten med t ex täckplast, max 3 bar vattentryck och rikta strålen rakt mot lamellerna
- fläktblad, fläktskydd och hölje.

Kontrollera vid igångkörning och periodvis att alla skruvar och elanslutningar är åtdragna.

FELSÖKNING

Motorn snurrar inte: kontrollera först elmatning innan vidare åtgärder. Kontrollera att fläktbladen roterar fritt.

Enheten vibrerar: kontrollera fläktblad och byt ut ev. skadade blad. Kontrollera att alla blad är isfria.

11. RESERVDELAR

TPi Klimatimport AB
www.tpiab.com
info@tpiab.com

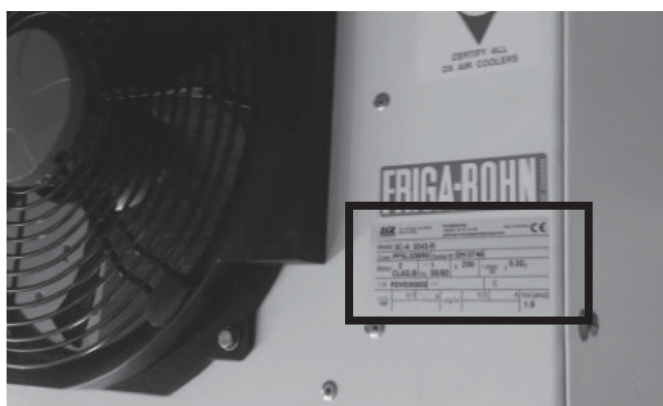



42 rue Roger Salengro - BP 205
69741 GENAS CEDEX - FRANCE
Tél. : + 33 4 72 47 13 00 - Fax : + 33 4 72 47 13 96

LENNOX EMEA reserverar sig för rätten att utföra ändringar när som helst utan avisering.



TPI Klimatimport AB
www.tpiab.com
info@tpiab.com